



Energy Park Fife

Facility to Support the Decommissioning Sector and Supply Chain

Scottish Enterprise and Fife Council are keen to engage interested parties in discussions on decommissioning and marine energy project investment opportunities at Energy Park Fife.

Key Facts:

- Extensive land based facility with direct quayside access
- East Coast Location - 14hrs transit from Central North Sea
- Total quay length 360m
- Water depth (min-max): 4.7m below Chart Datum
- Largest tonnage over quay to date is 22kt
- Options for a competitive cost structure
- Strength of Supply Chain on location and within Fife
- Logistics and Infrastructure Connections
- Supportive regulatory framework
- Ideally suited to a range of decommissioning, energy, manufacturing and R&D related activities

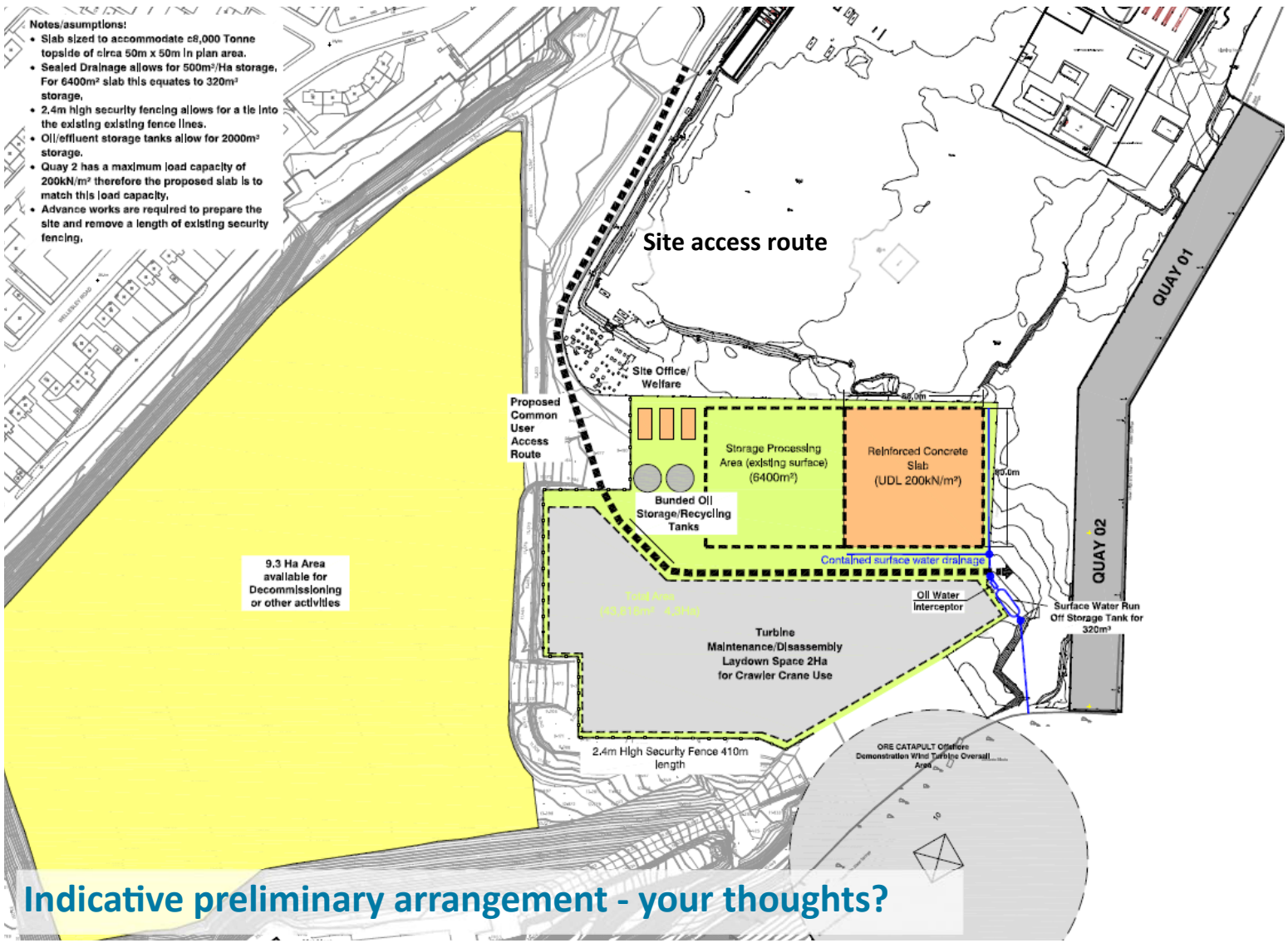

Fife and EPF are already a key location for engineering, energy, renewables and other related industry

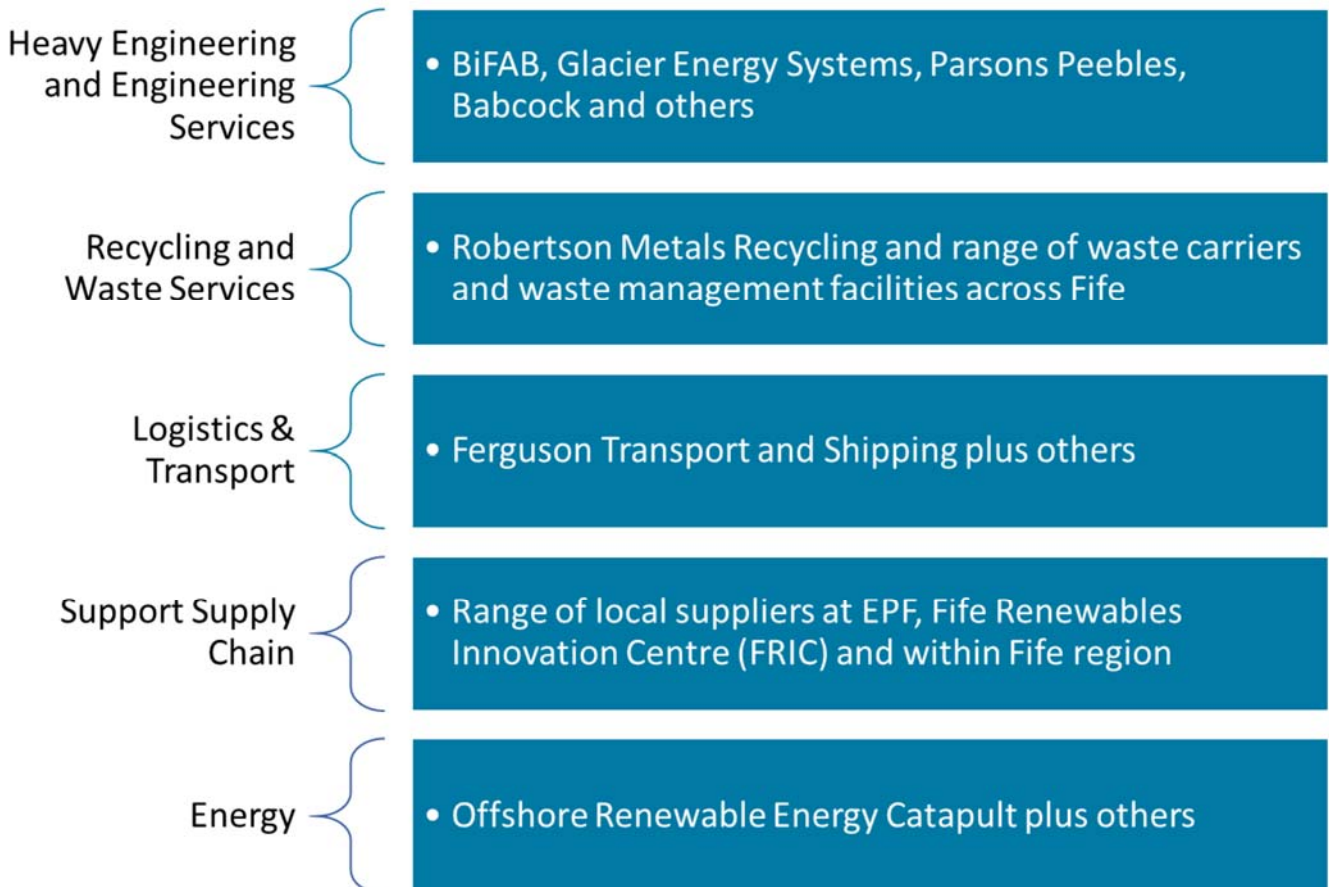

Energy Park Fife (EPF) is a market ready facility for decommissioning and associated activities. It comprises 138 acres (56Ha) of land with direct quayside access to the Firth of Forth and represents Scotland's premier heavy engineering site for energy, renewables, oil and gas and marine fabrication. A wealth of site data can be made available to interested parties.

Scottish Enterprise and Fife Council are keen to discuss opportunities in decommissioning with interested parties to potentially unlock future investment and partnership activity.

The facility provides an attractive, flexible east coast base for parties looking at a complimentary decommissioning location to support established Scottish activity in the sector as well as opportunities for new entrants with new ideas.

Opportunity for Investment?

Specialist decommissioning hardstanding with contained drainage

Space for associated decommissioning activities

Other considerations



| | |
|---------------------------------|-----------------------|
| Edinburgh International Airport | 30 miles – 45 minutes |
| Edinburgh | 32 miles – 45 minutes |
| Glasgow | 62 miles – 80 minutes |
| Glasgow International Airport | 72 miles – 90 minutes |





Interested in finding out more?

What do you think of current offer?

What would you like to see on site? Support to investment?

How do you see us working together?

Contacts

We would welcome early feedback from industry / contractors on key market opportunities, current market interest and investment requirements.

We are happy to arrange a convenient time to discuss further with you.

Ross Mackenzie

Lead Officer (Investment)

Economic Development,

Fife Council

Tel: 08451 555555 ext. 492178

E: ross.mackenzie@fife.gov.uk

Stuart Wilson

Infrastructure Team Leader

Scottish Enterprise

Tel: 01382 305546

E: stuart.wilson@scotent.co.uk